

D4K35

Amusement parks
Architecture
Auditoriums
Automotive design
Casinos

Museums
Planetariums
Theaters
Visualization



Unparalleled resolution and image quality

For Pro AV applications requiring the highest resolution, brightness and image and video quality, the Christie® D4K35 provides native 4K resolution (4096 x 2160), superior performance and durability.

The Christie D4K35, based on Christie's successful 1.38" 3-chip DLP® platform, has darker blacks, brighter whites and longer life expectancy when compared to other projection technologies.

Producing 32,500 ANSI (35,000 center) lumens, the Christie D4K35 offers the flexibility to use different lamp powers depending on your application needs. Its motorized lens mount, user replaceable lamps and field-alignable DMDs ensure that set up is fast and maintenance

times and costs are reduced. It ships standard with four 3G HD-SDI inputs, enabling native high quality (4:4:4, 12-bit) content to be displayed.

The Christie D4K35 is the high resolution, high brightness choice for large-sized applications such as amusement parks, auditoriums, automotive design, casinos, classrooms, museums, planetariums, theaters and visualization.

CHRISTIE®

D4K35 (129-004105-01)		
Image	brightness	<ul style="list-style-type: none"> • 32,500 ANSI lumens (35,000 center lumens) – 6.0kW Lamp • 27,000 ANSI lumens (29,000 center lumens) – 4.5kW Lamp • 18,000 ANSI lumens (19,500 center lumens) – 3.0kW Lamp • 12,000 ANSI lumens (13,000 center lumens) – 2.0kW Lamp
	contrast	• 2000:1 (full on/off)
Display technology	type	• 3-chip 1.38" DMD™
	native resolution	• 4K (4096 x 2160)
Lamp	type	• Xenon bubble ¹
	estimated life	• 6.0kW 750 hrs • 4.5kW 900 hrs • 3.0kW 2500 hrs • 2.0kW 3500 hrs
Input	signals standard	<ul style="list-style-type: none"> • 2 x 3G HD-SDI on board • 2 x 3G HD-SDI input card • 2 x HDMI 1.3 on board (physical DVI-I connectors)
	signals 2D	<ul style="list-style-type: none"> • 4K – 24/25/30Hz 4:2:2 10-bit (4 x 1.5G HD-SDI) • 4K – 24/25Hz 4:4:4 12-bit (4 x 3G-SDI) • 4K – 30Hz 4:4:4 12-bit (4 x 3G HD-SDI)² • 4K (3840 x 2160) – 24/25/30Hz 4:4:4 12-bit (4 x 3G-SDI) • 4K (3840 x 2160) – 24/25/30Hz 4:2:2 10-bit (4 x 1.5G HD-SDI) • 2K – 60Hz 4:4:4 8-/10-/12-bit (HDMI) scaled up to 4K • 2K – 30Hz 4:2:2 10-bit (1.5G HD-SDI) scaled up to 4K • 2K – 30Hz 4:4:4 12-bit (3G HD-SDI) scaled up to 4K • 1080p – 50/60Hz 4:2:2 10 bit (3G-SDI) scaled up to 4K • 1080p – 60Hz 4:4:4 8-/10-/12-bit (HDMI) scaled up to 4K
	signals 3D – triple flash ²	<ul style="list-style-type: none"> • 2K – 24Hz 4:4:4 12-bit (2 parallel 3G HD-SDI) scaled up to 4K • 2K – 24Hz 4:2:2 10-bit (2 parallel 1.5G HD-SDI) scaled up to 4K • 1080p – 24Hz 4:4:4 8-/10-/12-bit (2 parallel DVI-D) scaled up to 4K
	signals 3D – double flash ²	<ul style="list-style-type: none"> • 2K – 24Hz 4:4:4 12-bit (2 parallel 3G HD-SDI) scaled up to 4K • 2K – 24Hz 4:2:2 10-bit (2 parallel 1.5G HD-SDI) scaled up to 4K • 2K – 30Hz 4:4:4 12-bit (2 parallel 3G HD-SDI) scaled up to 4K • 2K – 30Hz 4:2:2 10-bit (2 parallel 1.5G HD-SDI) scaled up to 4K • 1080p – 24/25/30Hz 4:4:4 8-/10-/12-bit (2 parallel DVI-D) scaled up to 4K
Inputs/ control and networking	input	<ul style="list-style-type: none"> • RS-232 • Ethernet (10/100) RJ45 with ChristieNET™ connectivity • Detachable LCD control module
	type	<ul style="list-style-type: none"> • Tool-free lens insertion system • Boresight adjustable • Horizontal and vertical offset • Focus • Zoom
Lenses	fixed	• 0.72:1 (no offset) • 1.0:1 (Offset: Vertical: ± 29% Horizontal: ± 9%)
	zoom	<ul style="list-style-type: none"> • 1.13-1.31:1 (Offset: Vertical: ± 56% Horizontal: ± 19%) • 1.31-1.63:1 (Offset: Vertical: ± 13% Horizontal: ± 4%) • 1.63-2.17:1 (Offset: Vertical: ± 13% Horizontal: ± 4%) • 1.98-2.71:1 (Offset: Vertical: ± 13% Horizontal: ± 4%) • 2.71-3.89:1 (Offset: Vertical: ± 13% Horizontal: ± 4%) • 3.89-5.43:1 (Offset: Vertical: ± 13% Horizontal: ± 4%) • 5.43-7.69:1 (Offset: Vertical: ± 56% Horizontal: ± 19%)
Accessories	standard	<ul style="list-style-type: none"> • Detached 7kW low-ripple switch mode lamp ballast (required to operate projector) • Detachable LCD control module • AC line cord for projector head
	optional	<ul style="list-style-type: none"> • Heat extraction fan kit (required when operating projector) • CDXL-20 lamp • CDXL-30 lamp • CDXL-45 lamp • CDXL-60 lamp • Rack stand • Replacement air filter for light engine • Replacement air filter for liquid cooling radiator • Lamp adapter kit for CDXL-20
Power requirements	projector head	<ul style="list-style-type: none"> • Operating voltage: Single phase 200-240 VAC @ 50/60Hz • Operating current: 7A max @ 200V
	ballast	<ul style="list-style-type: none"> • Type: Detached 7kW low-ripple switch mode lamp ballast • Operating voltage: 3-phase 200-230 VAC @ 50/60Hz • Operating current: 38A per phase max • Operating voltage: 3-phase 380-415 VAC @ 50/60Hz • Operating current: 26A per phase max
Dimensions	size	<ul style="list-style-type: none"> • Projector head (LxWxH): 51.1 x 25.5 x 19" (1298 x 648 x 483mm) • Ballast (LxWxH): 21 x 18 x 21" (533 x 457 x 533mm)
	shipping size	<ul style="list-style-type: none"> • Projector head (LxWxH): 60.4 x 36 x 28.5" (1535 x 914 x 724mm) • Ballast (LxWxH): 28 x 25 x 31.5" (710 x 635 x 800mm)
	weight	• Projector head 251lbs (114kg) • Ballast 89lbs (40.5kg)
	shipping weight	• Projector head 322lbs (146kg) • Ballast 135lbs (62kg)
Operating environment	• Operating temperature: 50-95°F (10-35°C) • Humidity (non-condensing): 20-80%	
Regulatory approvals	<p>This product conforms to the following regulations related to product safety, environmental requirements and electromagnetic compatibility (EMC):</p> <ul style="list-style-type: none"> • Directives: (EC) 2002/95/EC (RoHS) • 2002/96/EC (WEEE) • Regulations: (EC) No. 1907/2006 (REACH) • CAN/CSA C22.2 No. 60950-1 • UL 60950-1 • IEC 60950-1 • FCC, Part 15, Subpart B, Class A • EN55022/CISPR22 Class A • EN55024/CISPR24 • Certifications marks (check with Christie for latest update): • cULus (Canada & US), CE (EU), CCC (China), GoST-R (Russia), KC (Korea), PSE (Japan), C-Tick (Australia & New Zealand) 	
Limited warranty	projector	• Three years parts and labor (including light engine)
	lamp	• Contact an authorized Christie representative for full details of our limited warranty



▲ Easy access to electronics, inputs and control



▲ Heat extraction fan kit required when operating projector



▲ Easy-to-use, detachable LCD control module



▲ Choose lamp power according to your application needs

Performance specifications are typical and are subject to change.

¹ User replaceable bulb.

² Some features may not be functional on initial product shipments but will be enabled via software upgrade when available.

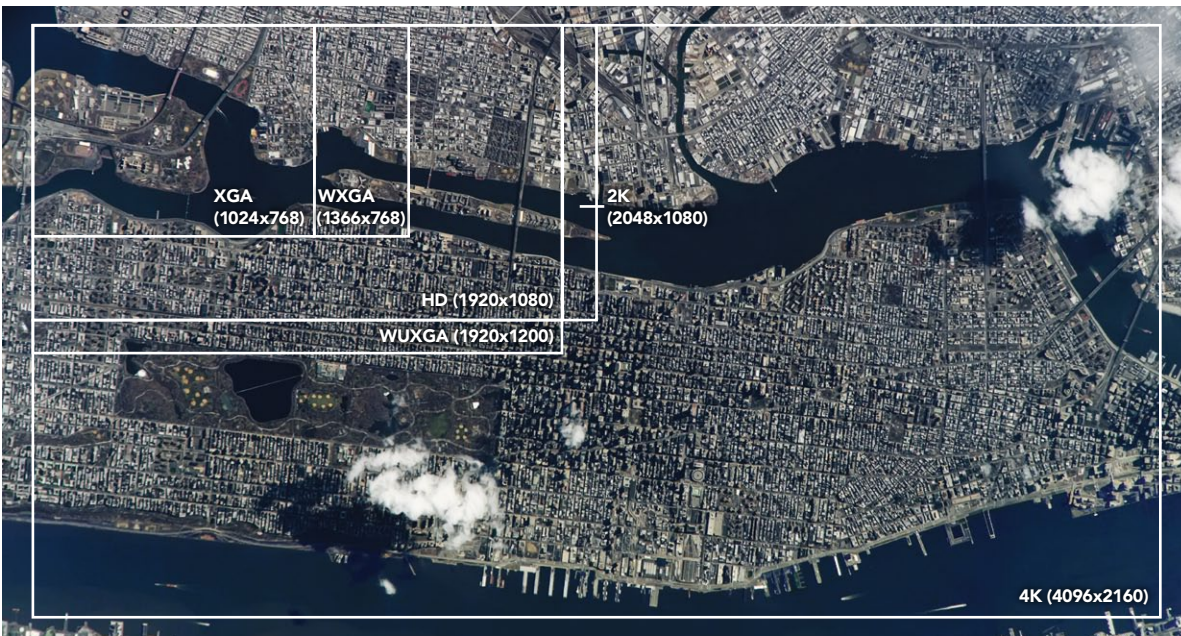

▶ Native 4K resolution ensures maximum impact for large-sized applications

Front view

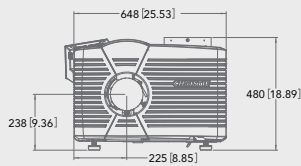

Top view

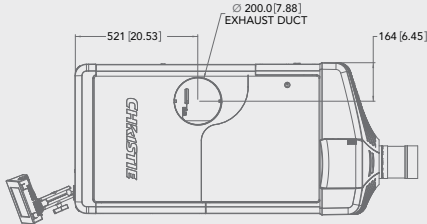

Side view

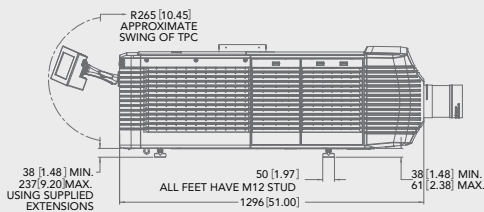

Bottom view

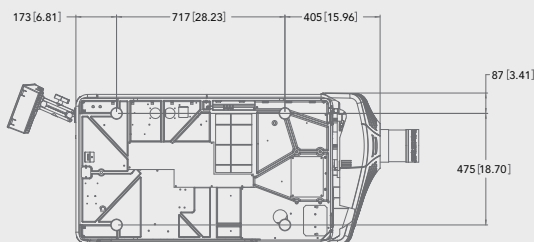

Ballast

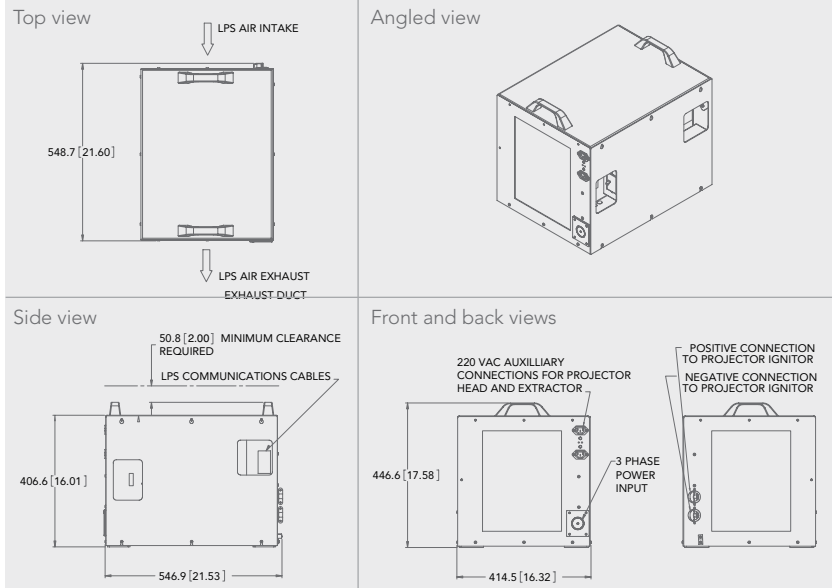

Miscellaneous Part number

Extraction fan kit ¹	• 38-814008-XX
Rack stand	• 108-282101-XX
7kW switching ballast ¹	• 129-003104-XX
Replacement air filter for light engine	• 003-001184-XX
Replacement air filter for liquid cooling radiator	• 003-003082-XX
Lamp adapter kit for CDXL-20	• 003-001728-XX

Lenses	Part number
0.8:1 Lens (2K) / 0.72:1 (4K)	• 113-104106-XX
1.1:1 Lens (2K) / 1.0:1 (4K)	• 38-809071-XX
1.25-1.45:1 Lens (2K) / 1.13-1.31:1 (4K)	• 38-809073-XX
1.45-1.8:1 Lens (2K) / 1.31-1.63:1 (4K)	• 38-809074-XX
1.8-2.4:1 Lens (2K) / 1.63-2.17:1 (4K)	• 38-809075-XX
2.2-3.0:1 Lens (2K) / 1.98-2.71:1 (4K)	• 38-809076-XX
3.0-4.3:1 Lens (2K) / 2.71-3.89:1 (4K)	• 38-809077-XX
4.3-6.0:1 Lens (2K) / 3.89-5.43:1 (4K)	• 38-809072-XX
5.5-8.5:1 Lens (2K) / 5.43:1-7.69:1 (4K)	• 38-809078-XX

Lamps	Part number
CDXL-20 lamp	• 003-000598-XX
CDXL-30 lamp	• 003-000599-XX
CDXL-45 lamp	• 003-000600-XX
CDXL-60 lamp	• 003-000601-XX

¹ Required when operating projector

Corporate offices

Christie Digital Systems USA, Inc.
USA – Cypress
ph: 714 236 8610

Christie Digital Systems Canada Inc.
Canada – Kitchener
ph: 519 744 8005

Independent sales consultant offices

Italy
ph: +39 (0) 2 9902 1161

South Africa
ph: +27 (0) 317 671 347

Worldwide offices

United Kingdom
ph: +44 (0) 118 977 8000

Germany
ph: +49 2161 664540

France
ph: +33 (0) 1 41 21 44 04

Spain
ph: +34 91 633 9990

Eastern Europe and
Russian Federation
ph: +36 (0) 1 47 48 100

United Arab Emirates
ph: +971 4 3206688

India
ph: +91 80 6708 9999

Singapore
ph: +65 6877 8737

China (Shanghai)
ph: +86 21 6278 7708

China (Beijing)
ph: +86 10 6561 0240

Japan (Tokyo)
ph: 81 3 3599 7481

Korea (Seoul)
ph: +82 2 702 1601



ISO 9001
ISO 14001

Kitchener, Ontario



For the most current specification information, please visit www.christiedigital.com



Copyright 2012 Christie Digital Systems USA, Inc. All rights reserved. All brand names and product names are trademarks, registered trademarks or tradenames of their respective holders. Christie Digital Systems Canada Inc.'s management system is registered to ISO 9001 and ISO 14001. Performance specifications are typical. Due to constant research, specifications are subject to change without notice. Printed in Canada on recycled paper. 3223 Mar 12

CHRISTIE[®]