

Installing the Harsh Environment Side Filter kit

The Harsh Environment Side Filter kit provides enhanced air filtration for Griffyn Series projectors. This kit is recommended in operating environments where smog, dust, or other particulates are affecting ambient air quality.



When the Harsh Environment Side Filter kit is installed on the projector, the Fan Profiles must be run in Performance mode.

Affected products

The following products are affected.

- Griffyn® Series
- Sapphire® 4K40-RGBH

Required components and tools

The following components and tools are required.

- Harsh Environment Side Filter kit (P/N: 163-195106-XX)
- 2.5 mm hex driver (included in projector tool kit)

Installing the Harsh Environment Side Filter kit

Follow these steps to install the Harsh Environment Side Filter kit.

1. Remove the harsh environment filter and frame from the box.
2. Remove the two center accessory screws from the projector frame.
Do not remove the side-intake cover.

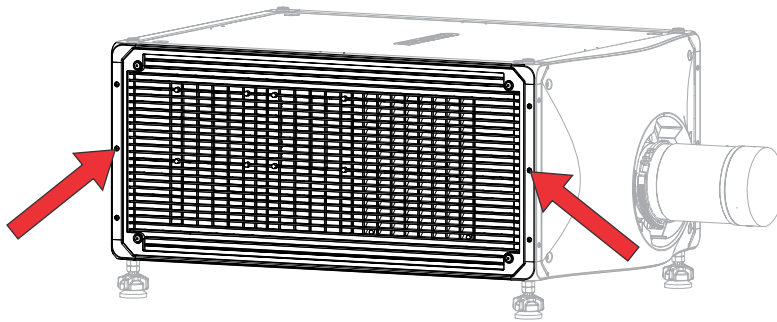

3. Peel off the backing from the double-sided adhesive.
4. Place the harsh environment filter frame on the side-intake cover and press down to adhere the tape to the cover and tighten the two screws to secure the filter frame to the projector frame.

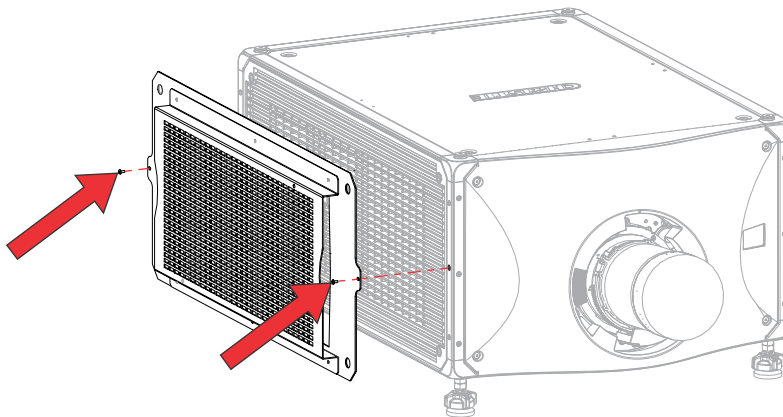

5. Unbag the filter and install the filter by sliding it in the open slot of the frame by compressing the spring tab, making sure to adhere to the air flow direction marked on the filter (highlighted by the blue arrow in the image below).

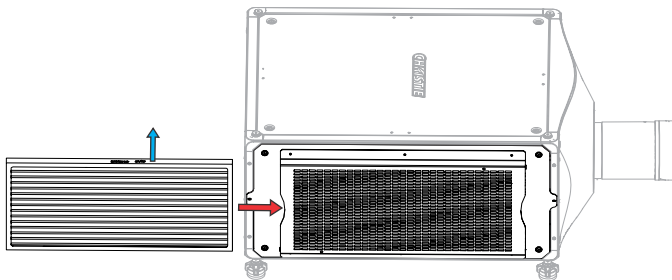

6. Refer to the line drawings for updated clearance numbers.
 - a) Go to www.christiedigital.com.
 - b) Sign into the Partner Portal.
 - c) Navigate to your projector model.
 - d) Switch to the **Downloads** tab and expand **Line drawings** section.
7. Set the fan profile to performance by selecting **MENU > System Settings > Power Settings > Fan Speed Profile > Performance**.

Technical support

Technical support for Christie Enterprise products is available at:

- North and South America: +1-800-221-8025 or *Support.Americas@christiedigital.com*
- Europe, Middle East, and Africa: +44 (0) 1189 778111 or *Support.EMEA@christiedigital.com*
- Asia Pacific (*support.apac@christiedigital.com*):
 - China: +86 10 6561 0240 or *tech-supportChina@christiedigital.com*
 - India: +91 (80) 6708 9999 or *tech-India@christiedigital.com*
 - Japan: 81-3-3599-7481
 - Singapore: +65 6877-8737 or *tech-Singapore@christiedigital.com*
 - South Korea: +82 2 702 1601 or *tech-Korea@christiedigital.com*