

# Lamp and Filter Replacement Instruction Sheet

---

## INTRODUCTION

Use the following instructions when replacing the lamp or filters in one of the projectors listed under **Kits Required**. Christie® recommends that lamps and filters be checked approximately every 1000 hours under normal operating conditions. Use only a Christie approved *Lamp and Filter Kit* for your projector model.

***When do I replace a lamp?*** Replace the lamp when it reaches its end of life or sooner if a noticeable degradation in brightness occurs. You can set the number of hours you expect to log with the lamp before replacing it, by setting the lamp limit in the lamp menu of the projector software. This setting should not exceed the lamp lifetime warranty. Enable the lamp message checkbox to provide a warning upon power up to indicate the lamp has reached the set lamp limit. At this time the lamp should be replaced.

## WARNINGS AND GUIDELINES

- ⚠ DANGER** EXPLOSION HAZARD! Lamps are under high pressure and may contain hazardous materials. Always wear an authorized full face shield and protective clothing to protect eyes and arteries when handling lamps.
- ⚠ WARNING** Lamp replacement must be performed by a qualified service technician.
- ⚠ WARNING** To avoid personal injury, always let the lamp cool completely before handling, and always handle the lamp by the housing only.
- ⚠ WARNING** Always use the correct wattage lamp supplied by Christie. Read the entire lamp replacement procedure and all warnings before servicing.
- ⚠ WARNING** Never touch the glass surface of the lamp. Fingerprints left on the surface can lead to an intense accumulation of heat called a "hot spot", which could potentially result in lamp explosion during normal operation.

**KITS REQUIRED**

<b>PROJECTOR MODEL</b>	<b>WATTAGE</b>	<b>LAMP/FILTER KIT REQUIRED</b>
DLV1400-DX DLV1920-DX Matrix HD2 Matrix WU2 Christie HD2Kc Matrix S+2K Mirage HD3 Mirage WU3 Christie HD3K Mirage S+3K	500W	003-120118-XX
Matrix 4000 Matrix HD4 Christie DW4Kc Matrix WU5 Christie DS+5Kc Christie HD5Kc Christie DW5K Matrix S+5K Christie DS+6K Mirage S+6K Christie HD6K Mirage HD6 Mirage WU7	1000W	003-120117-XX
Christie DW6Kc Matrix HD7 Christie HD7Kc Christie DS+8K Christie DW8K Christie HD8K	1200W	003-120116-XX
HD7K-J Mirage HD7K-J Mirage WU7K-J Matrix WU7K-J DS+8K-J Mirage DS+8K-J	1000W	003-004084-XX
HD9K-J DS+10K-J	1200W	003-004085-XX

**TOOLS REQUIRED**

- #2 Phillips screwdriver
- Personal protective equipment (lint-free gloves, full face shield)

## INSTRUCTIONS

### Remove the Lamp Module

1. Press power twice to switch the lamp off. Allow the cooling fans to stop automatically (within 5 minutes) before proceeding with step 2.

**NOTE:** *This wait period is required to allow the lamp to sufficiently cool before handling.*

2. When the cooling fans have stopped, unplug the projector.
3. Loosen (2) #2 Phillips® self retaining screws to open the lamp door. Remove the lamp door.  
**NOTICE!** *The lamp door is not tethered.*

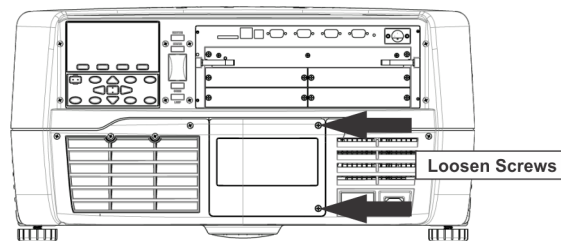

4. Pull back and turn the locking lever counter clockwise to the 12 o'clock position to unlock the lamp module for removal.

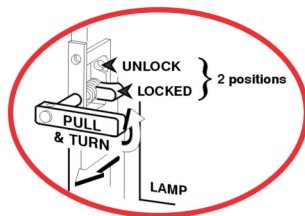

UNLOCKED LATCH

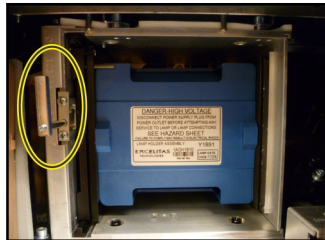

LOCKED LATCH

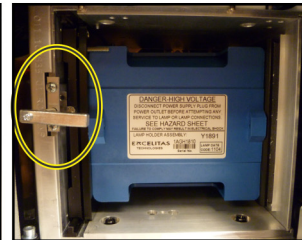

5. Grasp the body of the lamp housing at the top and the bottom. Pull the lamp module straight back to remove it from the projector.

**⚠ CAUTION** Keep knuckles raised in order to prevent injury.

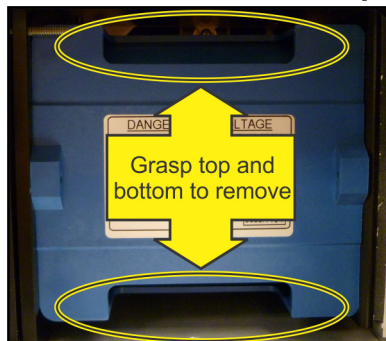

## Install the Lamp Module

1. Verify that the lamp memory board - located on the rear left of the lamp - is not obstructed. If it is covered with a plastic protector, remove it before installing the lamp. Failure to do this will hamper the proper installation of the lamp and prevent normal operation.
2. Record the serial number of the new lamp.
3. Align the new lamp with the top and bottom guides on the left side of the lamp compartment. Slide the lamp all the way in – a slightly harder push may be required right at the end to make sure the lamp is fully seated into the terminal block.

**NOTE:** The lamp module must make full contact with the terminal block. The projector will not power up again if the lamp is not fully connected to the terminal block.

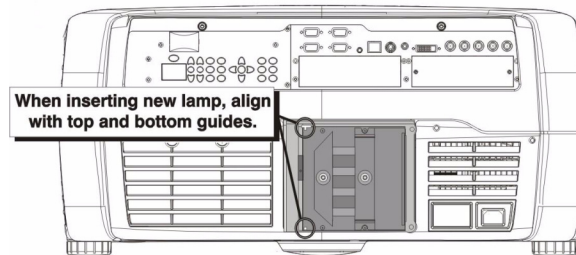

4. Pull and turn the locking lever clockwise to 3 o'clock to secure the lamp module.
5. Install the lamp door and secure (2) #2 Phillips® self retaining screws.
6. Plug in and power on the projector and navigate to the lamp menu. Select **CHANGE LAMP**. This will prompt for the old lamp serial number (if it was not previously entered). Enter the new lamp serial number.

**NOTE:** This action is not mandatory, it is recommended for accurate lamp statistics to be archived. If you neglect to enter a serial number, the lamp times will not reset to “0” and will therefore be inaccurate, in which case, the lamp life limit will expire prematurely.

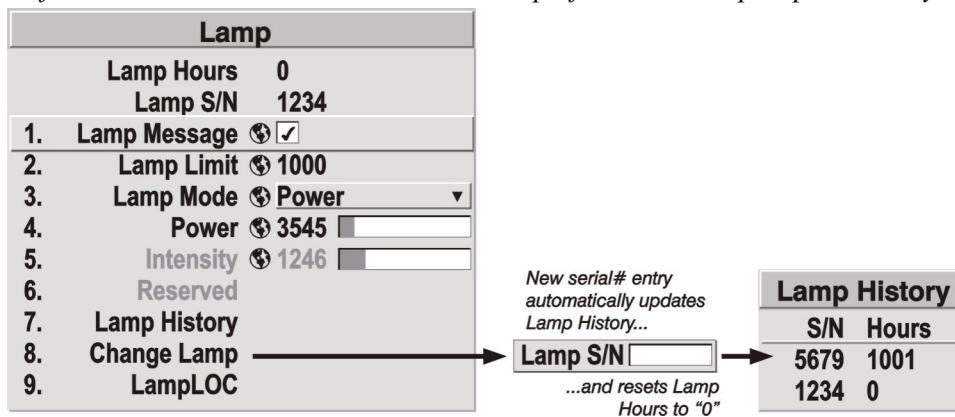

## Replace the Air Filter

### J Series Projectors:

1. Loosen (2) #2 Phillips® self retaining screws on the filter cover.
2. Remove the filter cover
3. Remove the filter and discard. Do not reuse filters.
4. Insert the new filter.
5. Install the filter cover and secure with (2) #2 Phillips® screws.

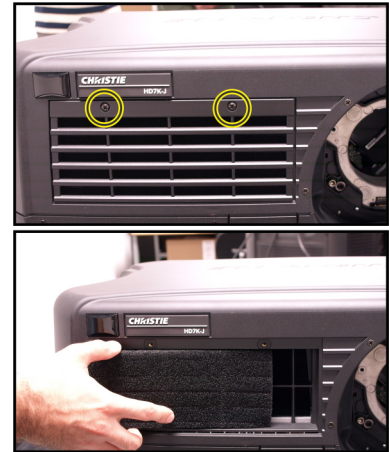

### Non-J Series Projectors:

1. Loosen (4) #2 Phillips® screws on the filter access panels. (Front access panel located to the left of the lens - 1 screw. Left side access panel - 3 screws.)

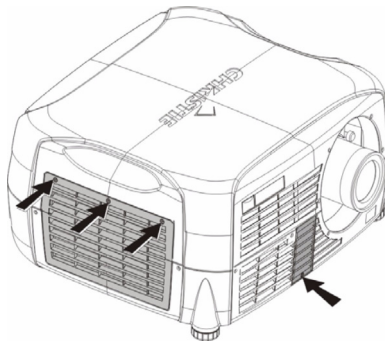

2. Pull the old filters out of the projector and discard. Do not reuse filters. Insert the new filters with the wired side in.

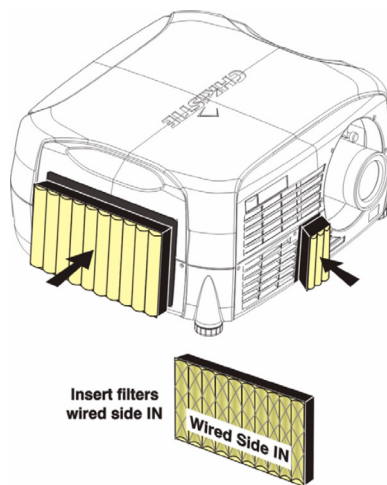

3. Install the filter access panels and secure with (4) #2 Phillips® screws.

**TECHNICAL SUPPORT CONTACT INFORMATION****NORTH AMERICA****Christie Digital Systems, Inc.**

809 Wellington Rd. North  
Kitchener, Ontario, Canada N2G 4Y7  
Tel: 519-744-8005 (General)  
Fax: 519-749-3302 (Service)  
Toll Free: 1-800-221-8025 (Technical Support)

**Christie Digital Systems, Inc.**

10550 Camden Drive  
Cypress, CA 90630 USA  
Tel: 714-236-8610 (General)  
Fax: 519-749-3302 (Service)  
Toll Free: 1-800-221-8025 (Technical Support)

**EUROPE****Christie Digital Systems, Inc.**

ViewPoint  
200 Ashville Way  
Workingham, Berkshire RG412PL  
United Kingdom  
Tel: +44-118-977-8111  
Fax: +44-118-977-8112

**Christie Digital Systems, Inc.**

Willicher Damm 129  
D-41061 Mönchengladbach  
Germany  
Tel: +49-2161-664540  
Fax: +49-2161-664546

**Christie Digital Systems, Inc.**

7, av Georges Pompidou  
92593 Levallois-Perret Cedex  
France  
Tel: +33-(0)1-47-48-28-07  
Fax: +33-(0)1-47-48-26-06

**ASIA-PACIFIC/OTHER****Christie Digital Systems, Inc.**

627A Aljunied Road  
# 05-02 Biz Tech Center  
Singapore 389842  
Tel: 65-6877-8737  
Fax: 65-6877-8747

**Christie Digital Systems, Inc.**

Rm. 1109-1116 Shartex Plaza  
No. 88 Zun Yi South Road  
Shanghai, 200336  
People's Republic of China  
Tel: +86-21-6278-7708  
Fax: +86-21-6270-5816