

REVISION HISTORY OF: 020-000371-01			
REV	DESCRIPTION OF CHANGE	BY	REV DATE
01	INITIAL RELEASE	RG	10/29/2010
02	UPDATED RELEASE	JB	06/28/2011

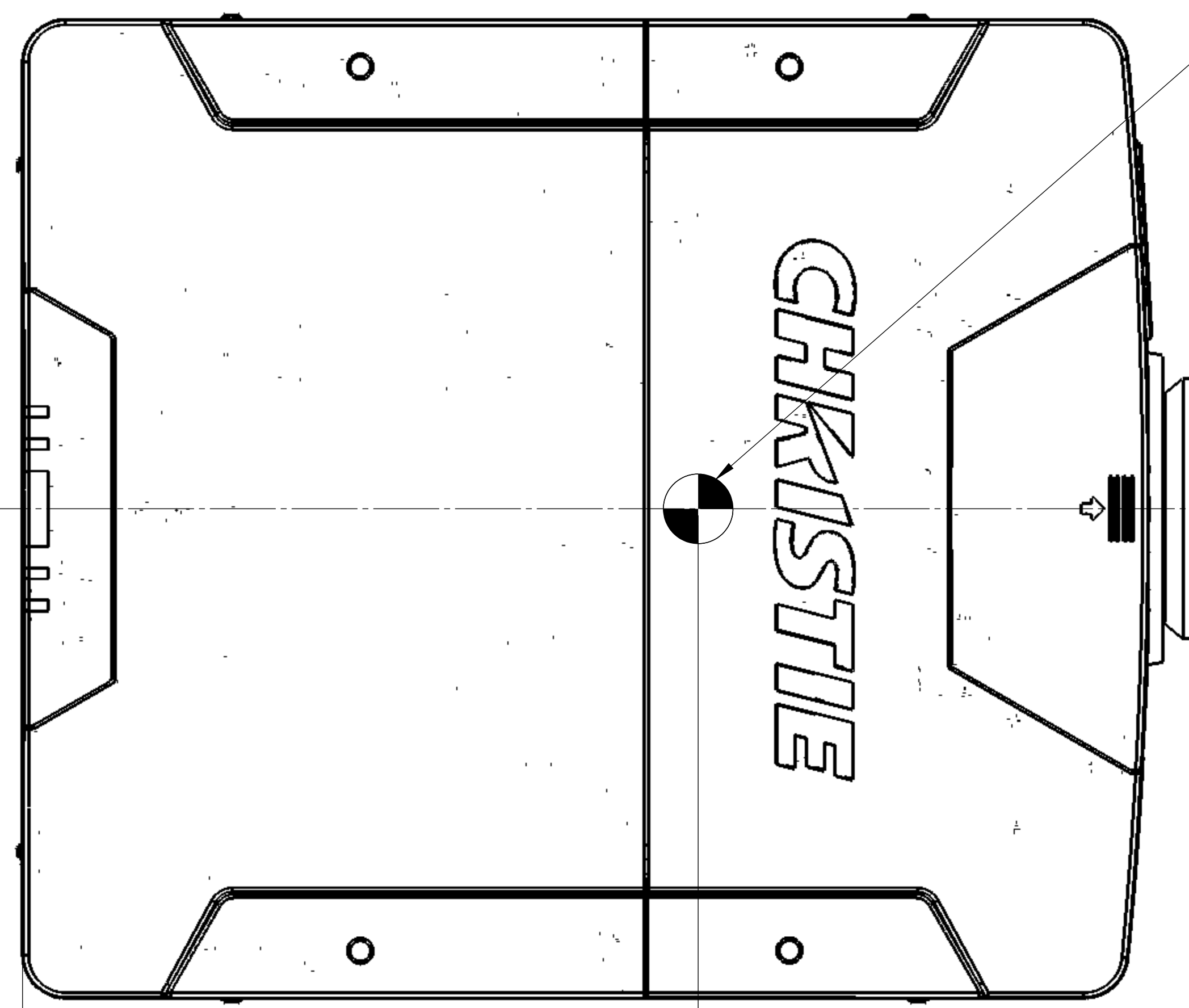

CENTER OF GRAVITY

CENTER OF GRAVITY  
315.0±20.0 [ 12.40±.79 ]  
VARIES WITH PROJECTION LENS

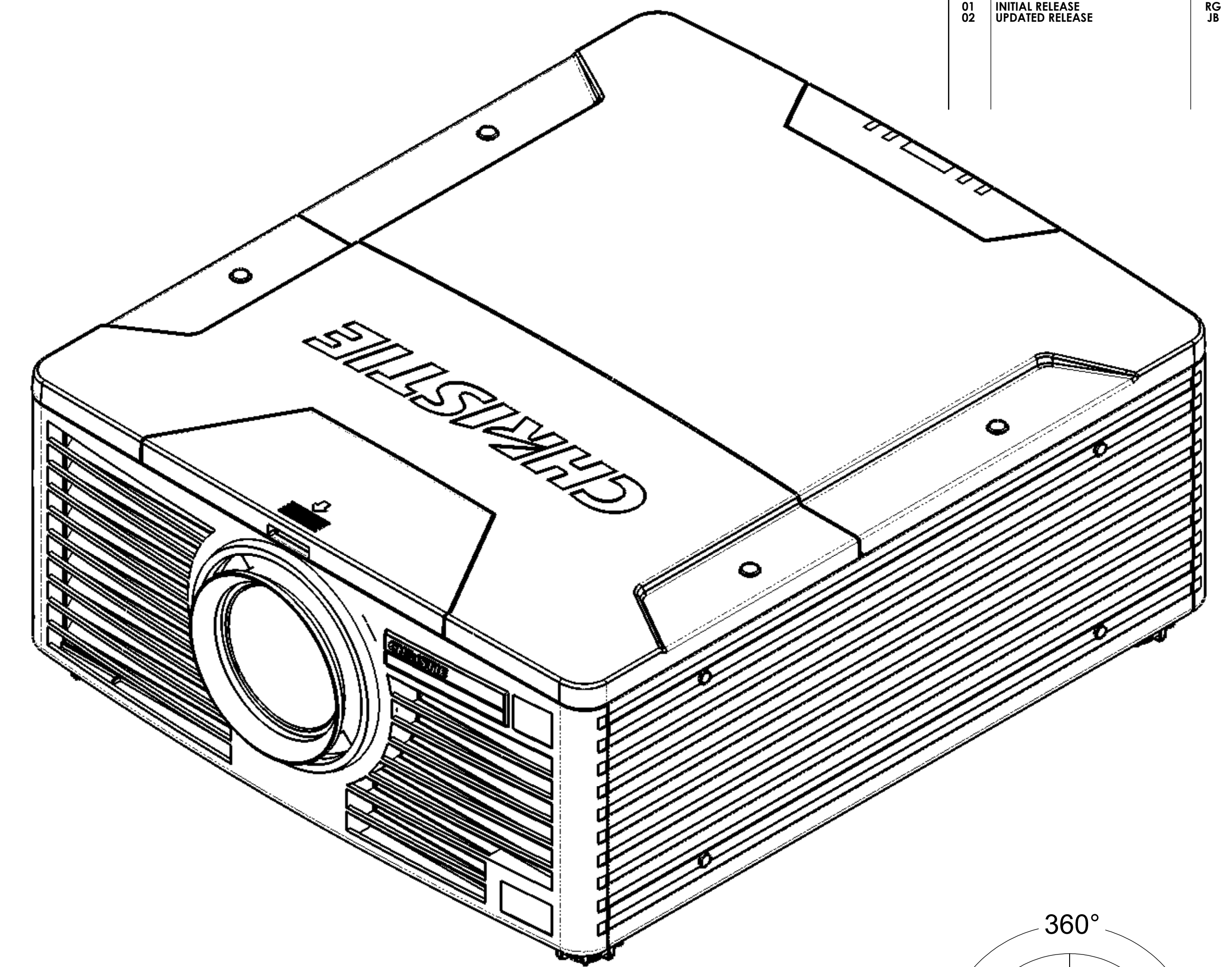

ISOMETRIC VIEW

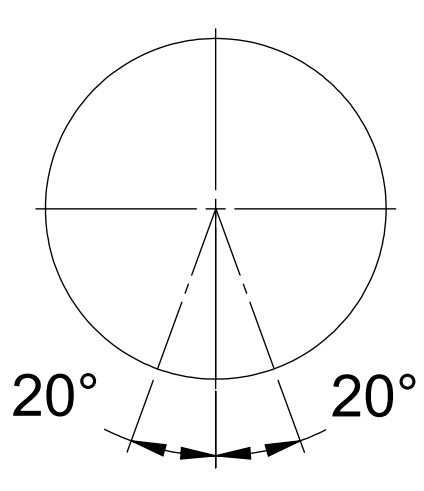

ROLL (+/- 20 DEGREES)

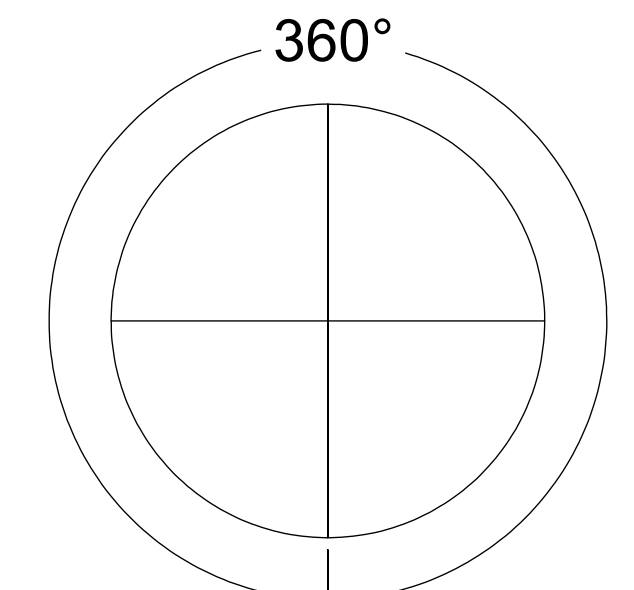

PITCH (360 DEGREES)

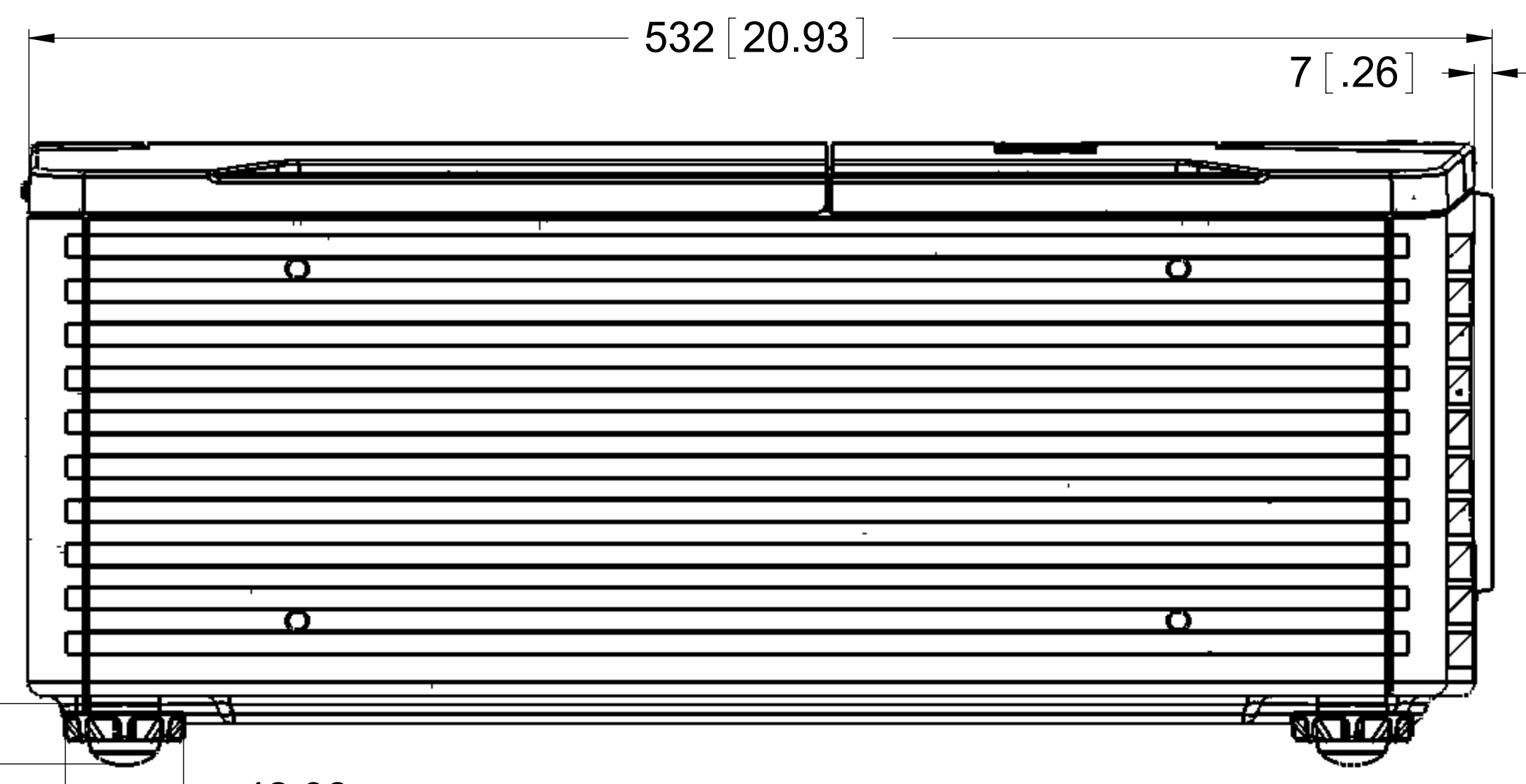

22 [.87] MIN  
27.7 [1.09] MAX

ALL FEET ARE M6 STUD

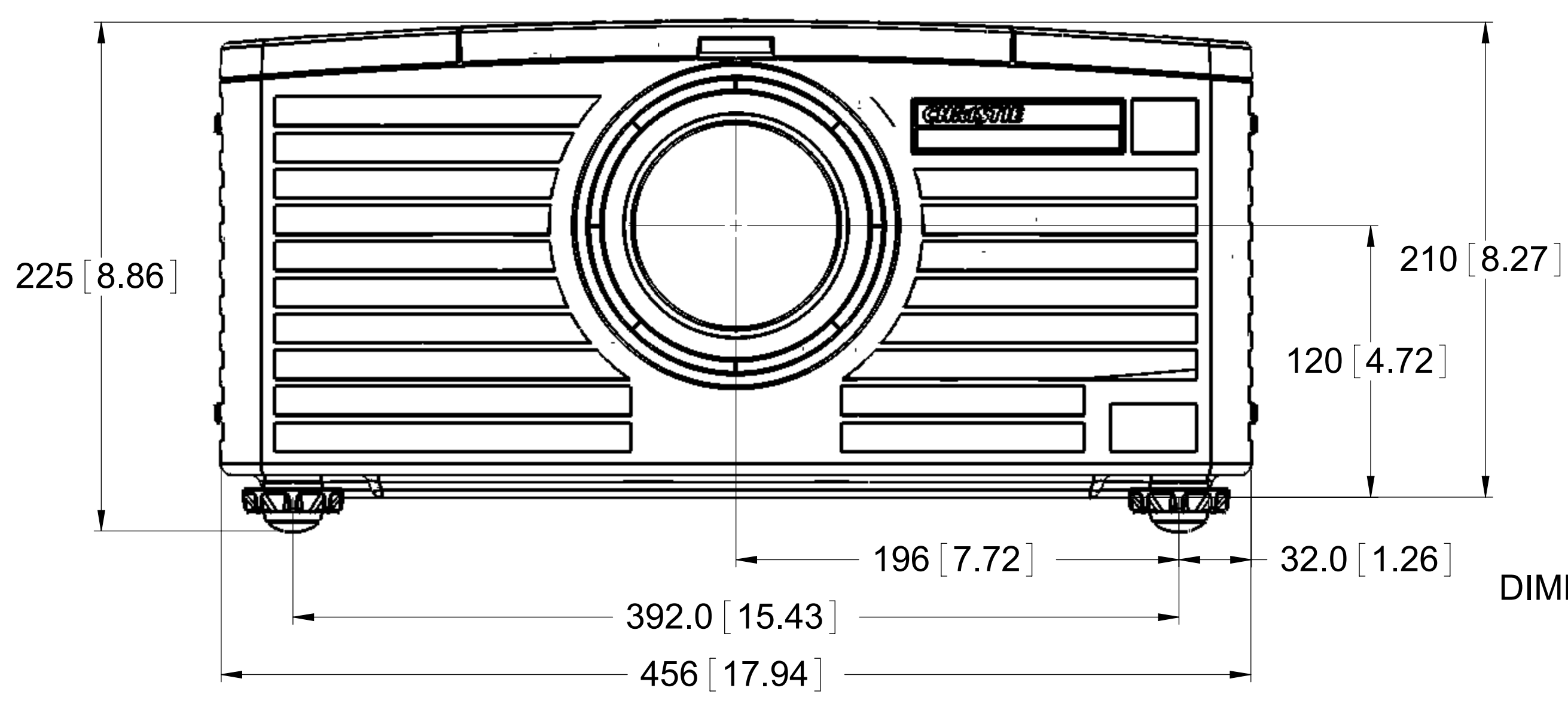

DIMENSION "A"



DIMENSION "B"

DIMENSION "C"

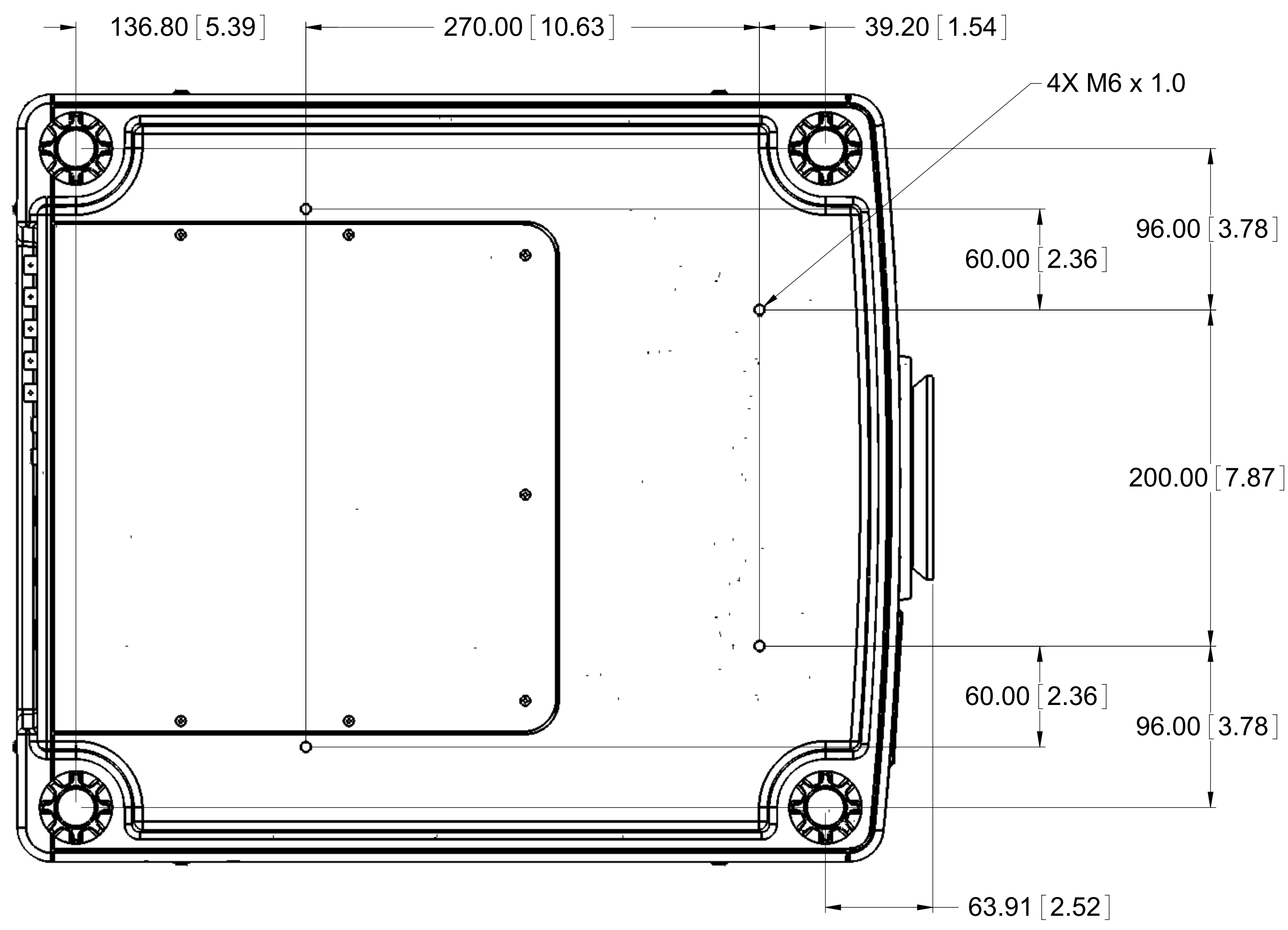

4X M6 x 1.0

LENS	DIMENSION 'A'	DIMENSION 'B'	DIMENSION 'C'
133-100102-01	13mm [0.53"]	64mm [2.53"]	545mm [21.45"]
133-101103-01	60mm [2.36"]	111mm [4.36"]	591mm [23.28"]
133-102104-01	13mm [0.52"]	64mm [2.53"]	545mm [21.45"]
133-103105-01	55mm [2.18"]	106mm [4.19"]	587mm [23.11"]
133-104106-01	72mm [2.84"]	123mm [4.84"]	604mm [23.76"]

GENERAL NOTES:  
 MASS: 19.5 kg (45 lbs) WITHOUT LENS  
 AMBIENT AIR TEMPERATURE: 40°C (104°F) MAX.  
 POWER REQUIREMENTS: 100-240 V, 50-60 Hz, 9.2A

UNITS: INCHES [ ] MILLIMETRES [X]	DRAWN BY: J. BOGARD	CHRISTIE DIGITAL SYSTEMS USA, INC.
UNLESS OTHERWISE SPECIFIED INTERFERE DIMENSIONS AND TOLERANCES PER ASME Y14.5M-1994	DATE: 05/14/2011	CHRISTIE DIGITAL SYSTEMS CANADA, INC.
TOLERANCES APPLY AS SHOWN BELOW	APPROVED BY: L. PHEE	
DECIMAL PLACES: .XXX ± 0.03, .XX ± 0.13, .X ± 0.25	DATE: 06/08/2011	
ANGULAR DIMENSIONS: XX' ± 0.5', XX.X' ± 0.9'	PROPRIETARY	PART DESCRIPTION
	NOT TO BE DISCLOSED OR REPRODUCED IN ANY MANNER WITHOUT THE EXPRESS WRITTEN PERMISSION OF CHRISTIE	DWG LINE E-SERIES
	THIRD ANGLE PROJECTION	020-000371-01
		020-000371-01
		1-2 MASS: - LBS [ - KG ] SHEET 1 OF 4

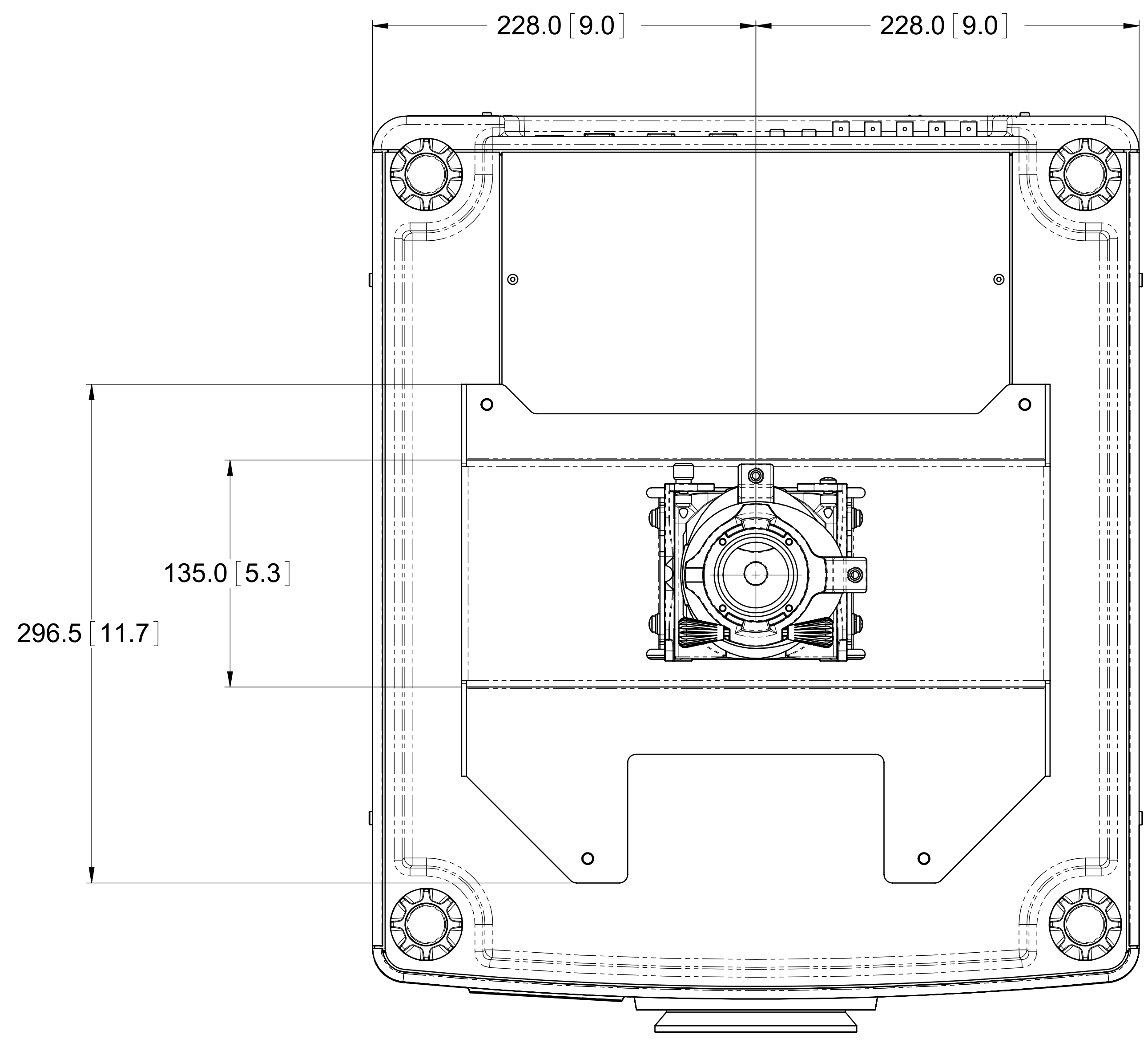

**CEILING MOUNT E-SERIES**  
133-106108-XX

CEILING MOUNT SPECIFICATION	
ROLL	+/- 5°
PITCH	+ 5°/- 15°
YAW	+/- 20°
COLOUR	BLACK
WEIGHT CAPACITY	65 LBS (29.5 KG)

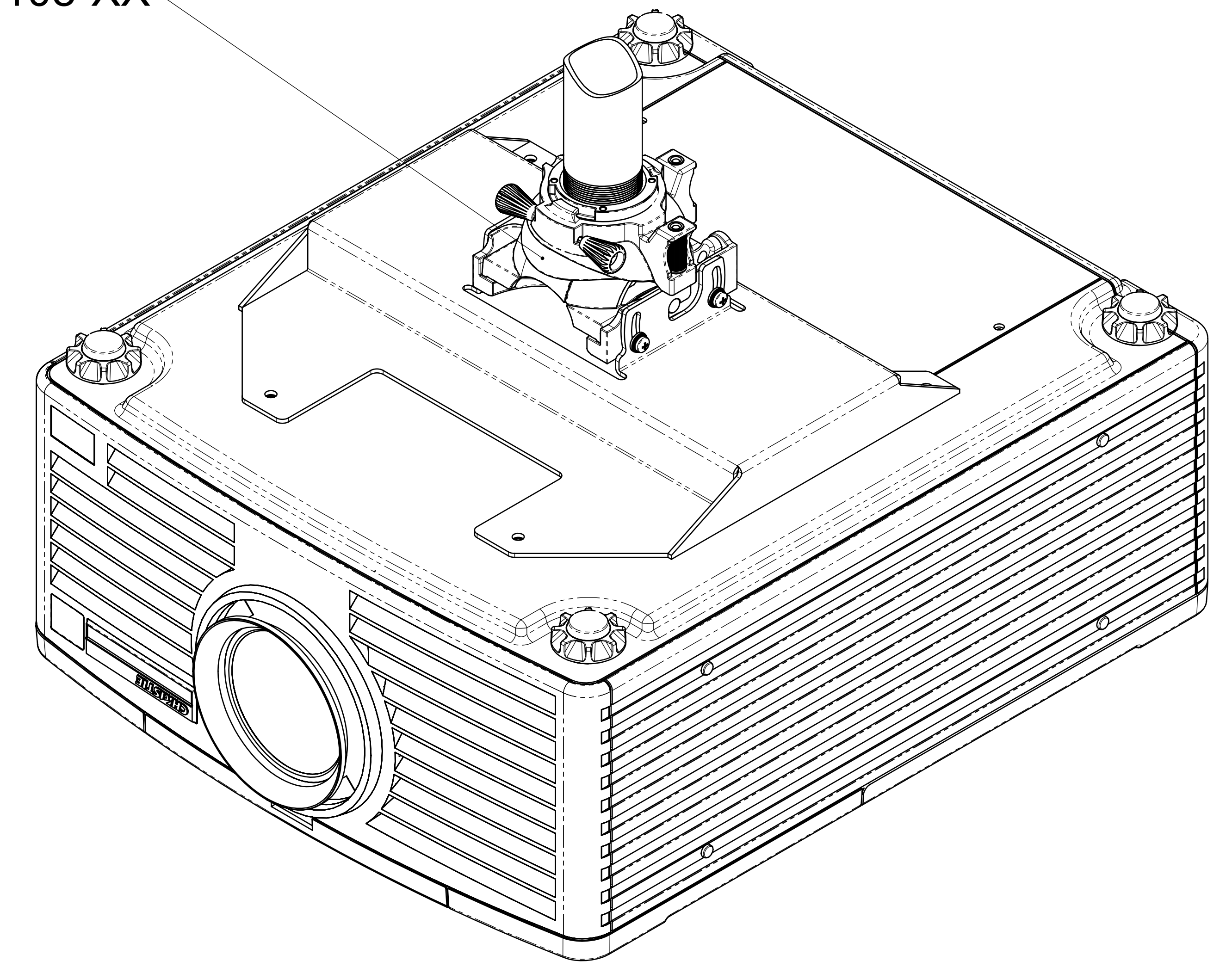

**ISOMETRIC VIEW**

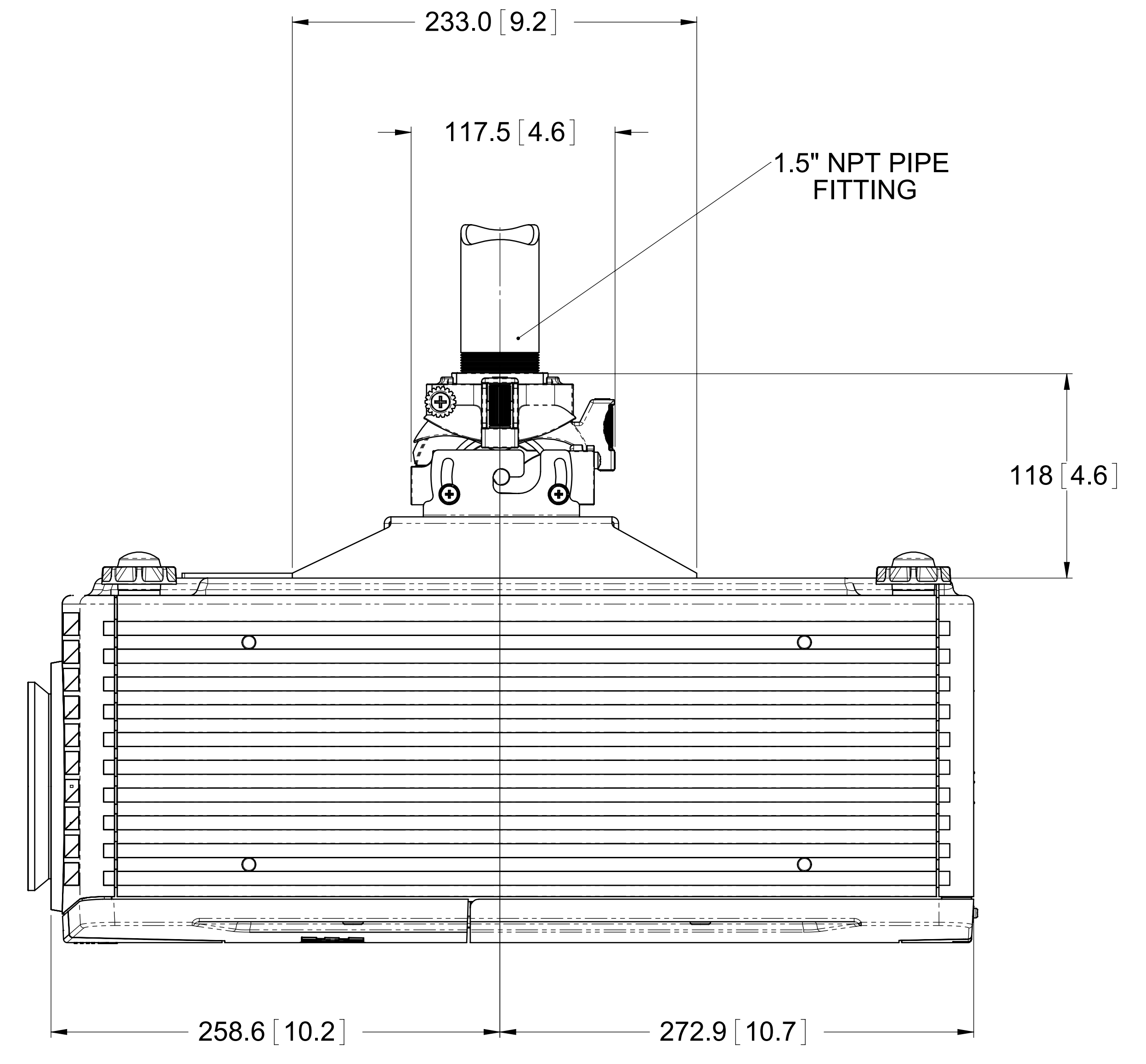
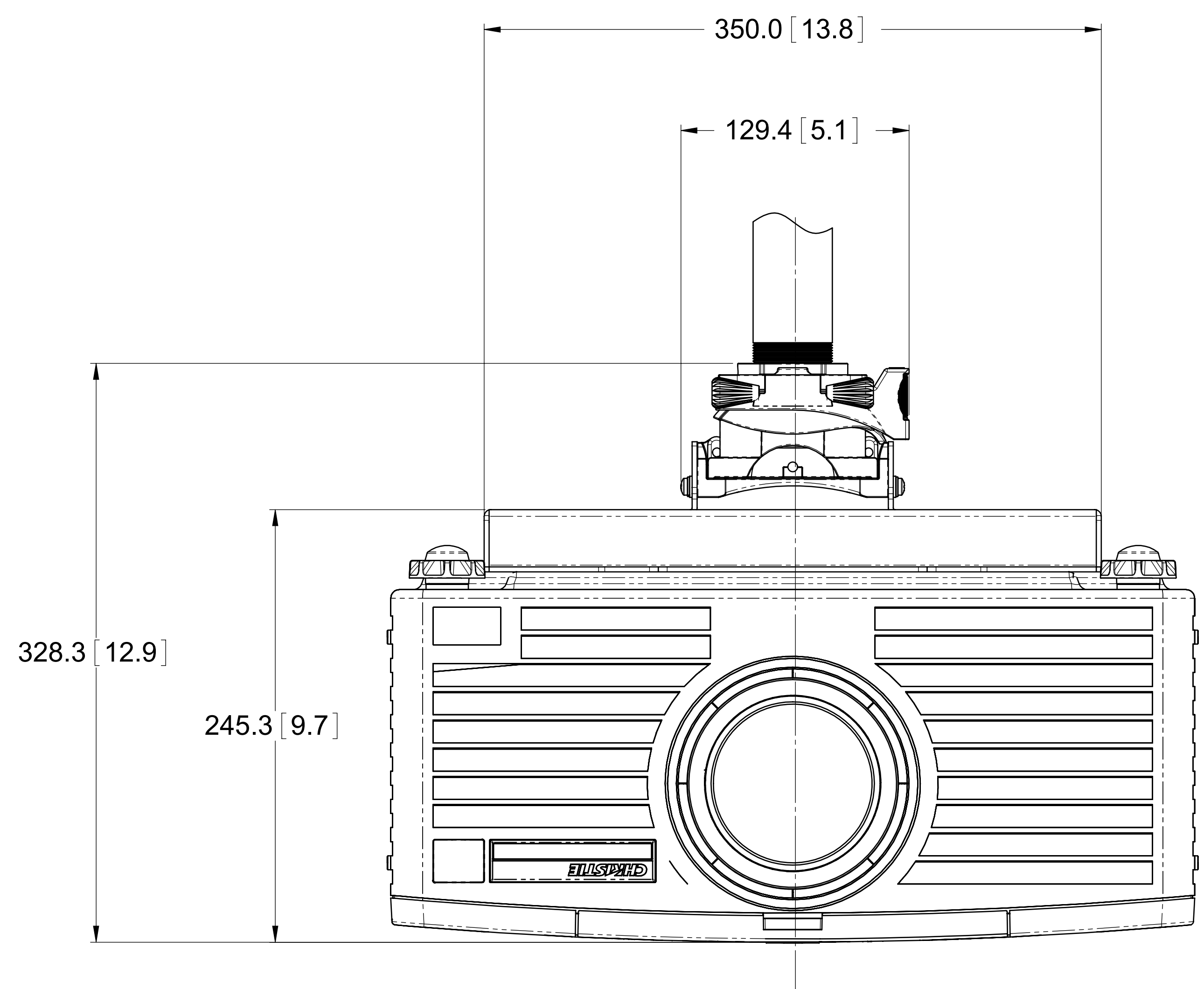

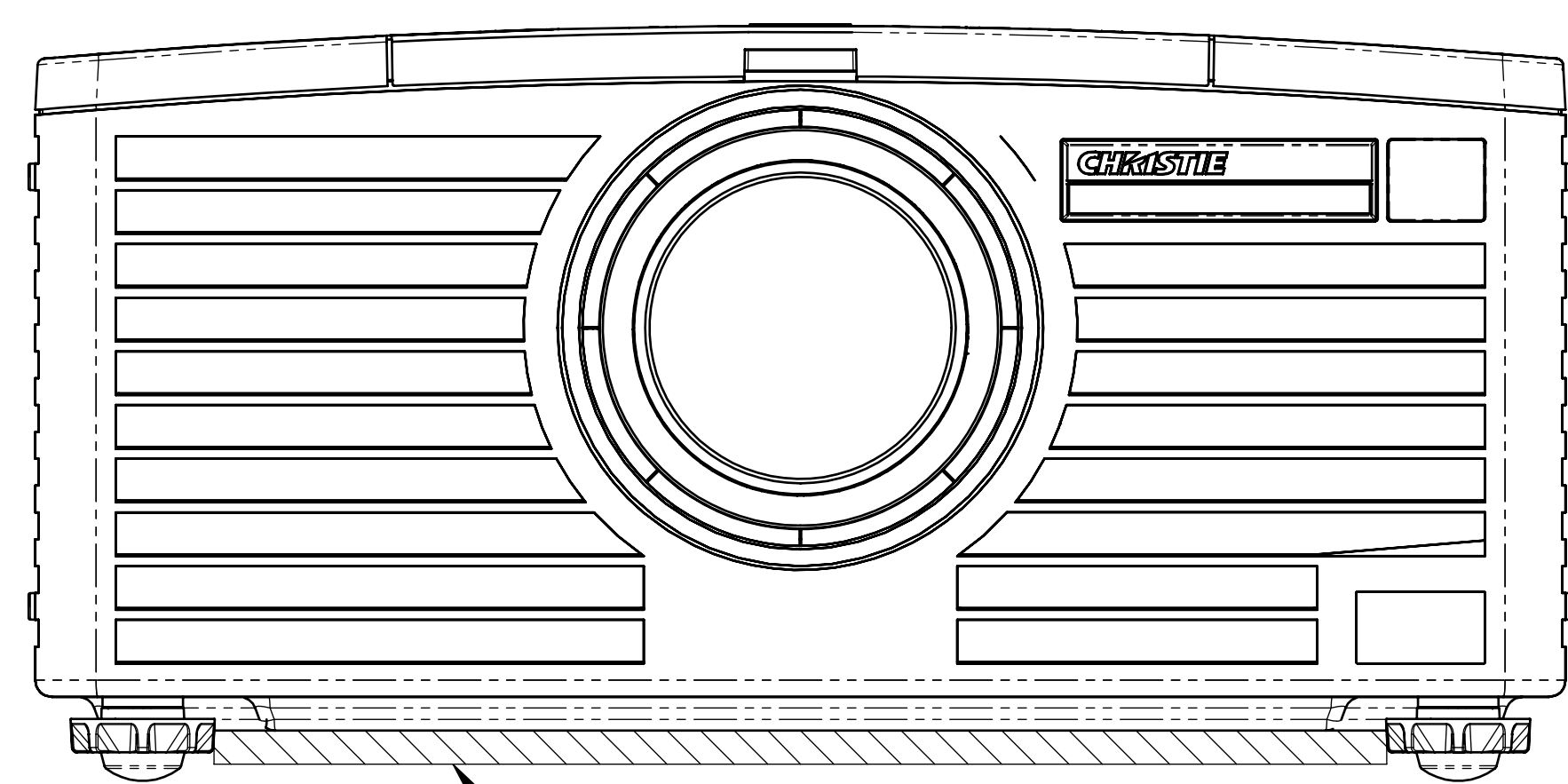
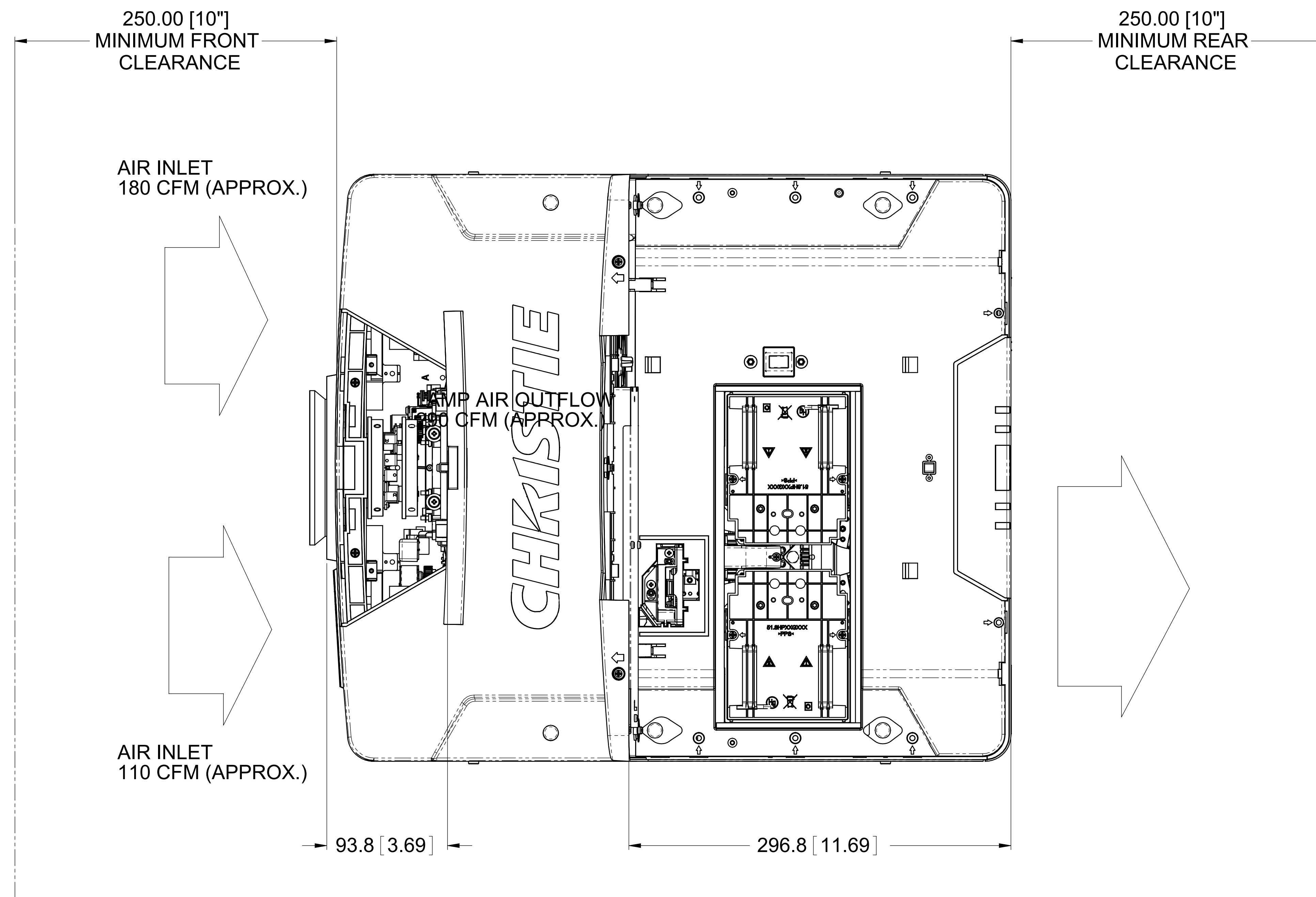

10.0mm GAP REQUIRED FOR AIRFLOW

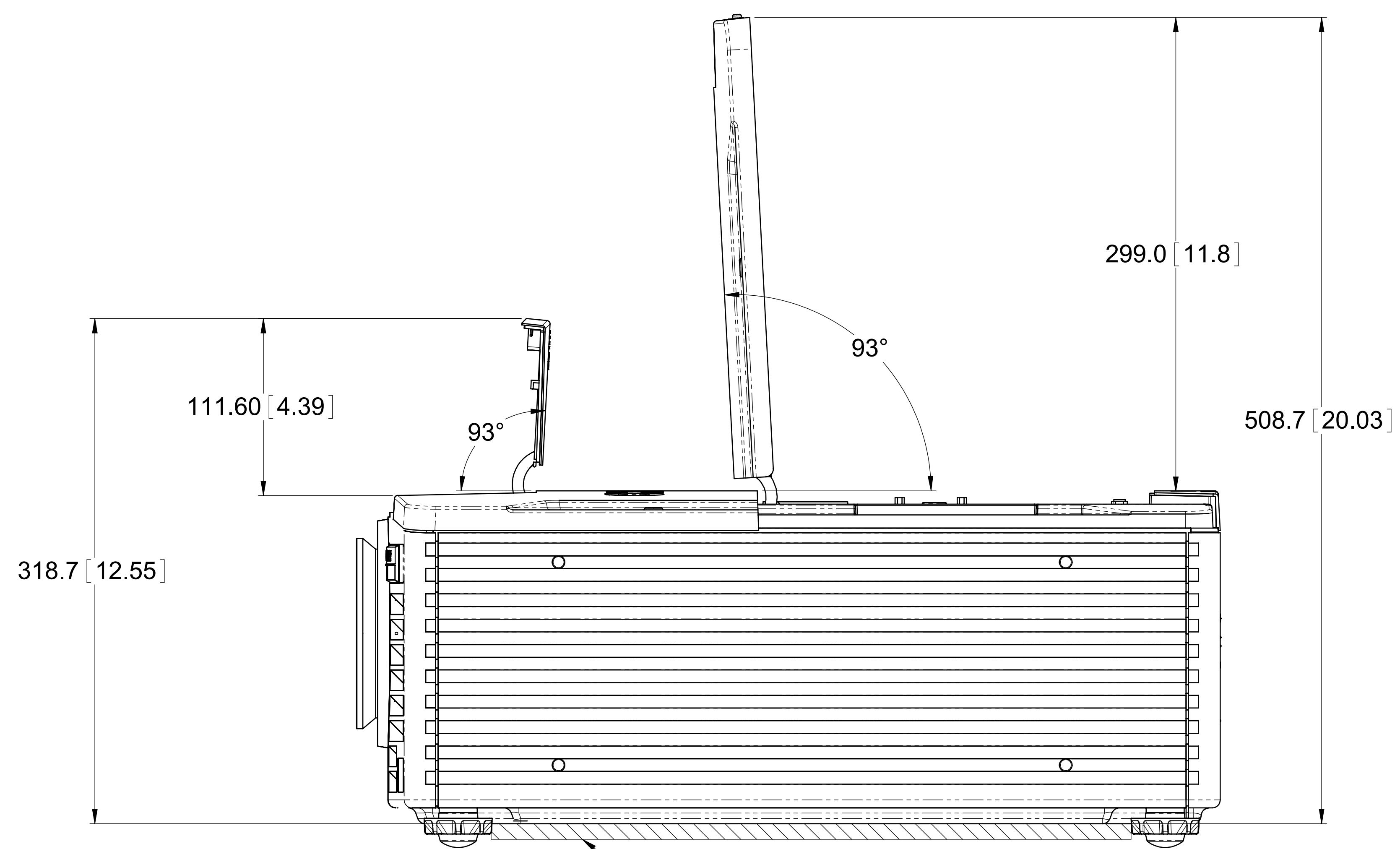

10.0mm GAP REQUIRED FOR AIRFLOW

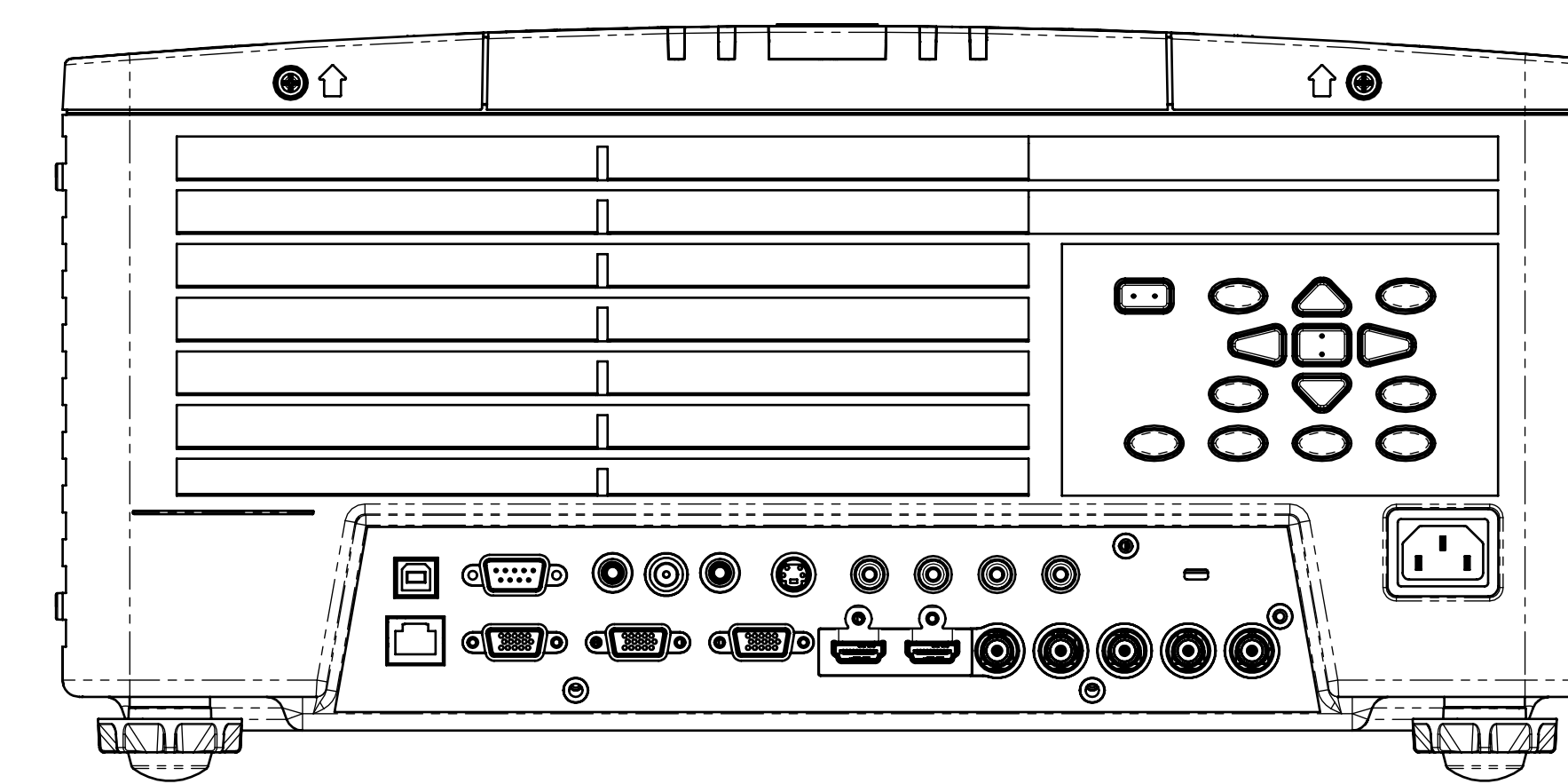

# PROJECTION LENSES

**133-100102-XX**  
0.8:1 FIXED SHORT

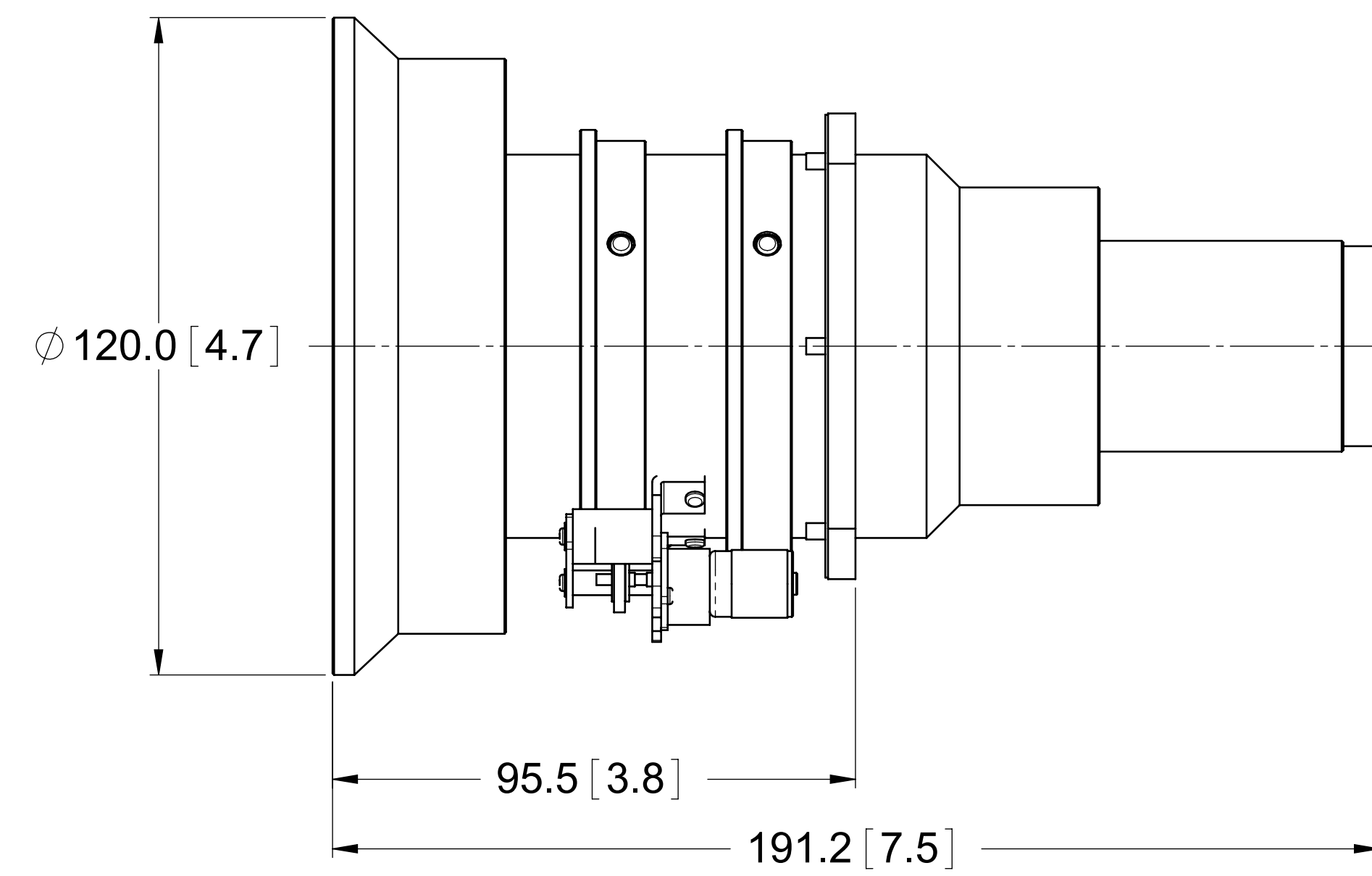

**133-103105-XX**  
2.0-4.0:1 ZOOM

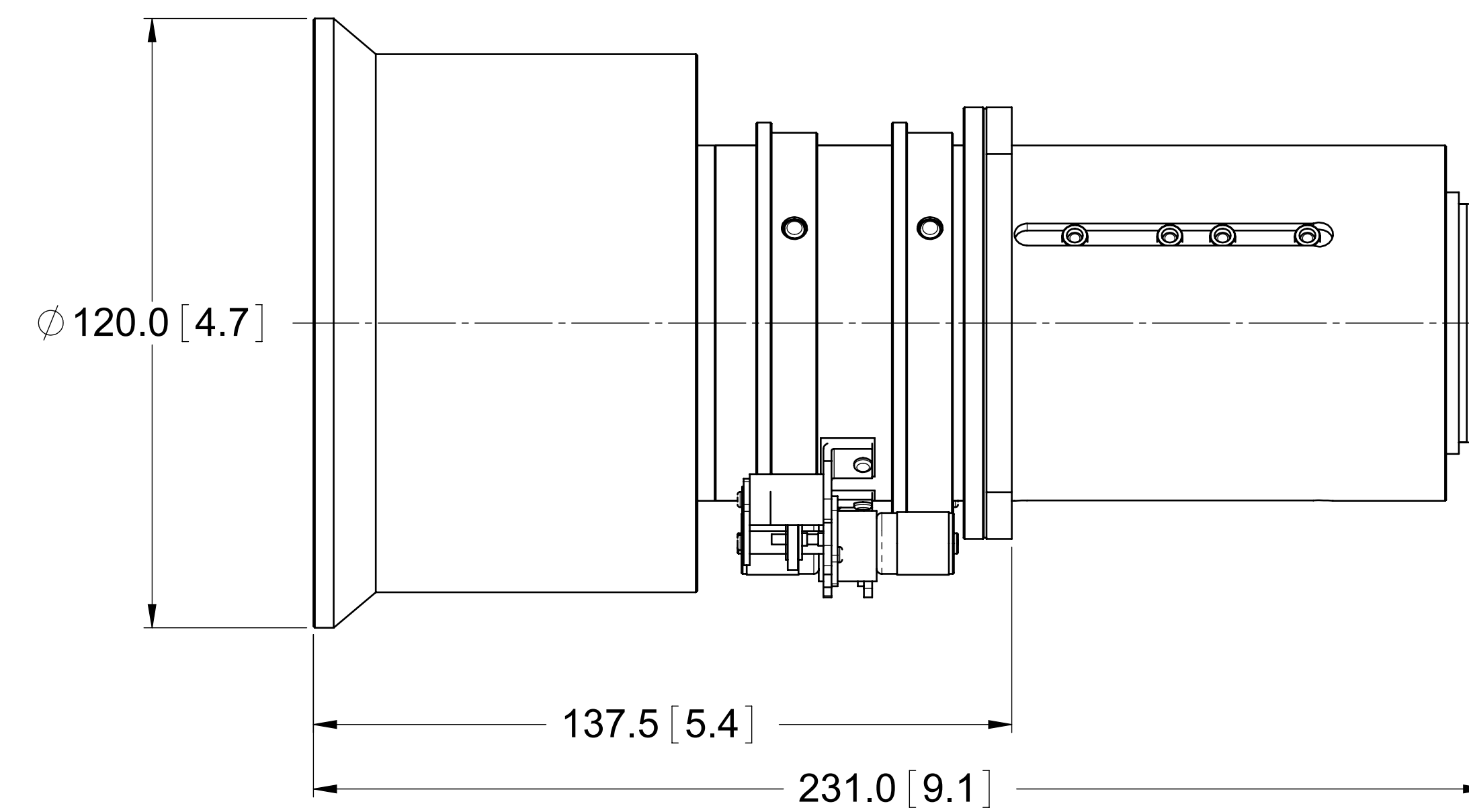

**133-101103-XX**  
1.2-1.5:1 SHORT ZOOM

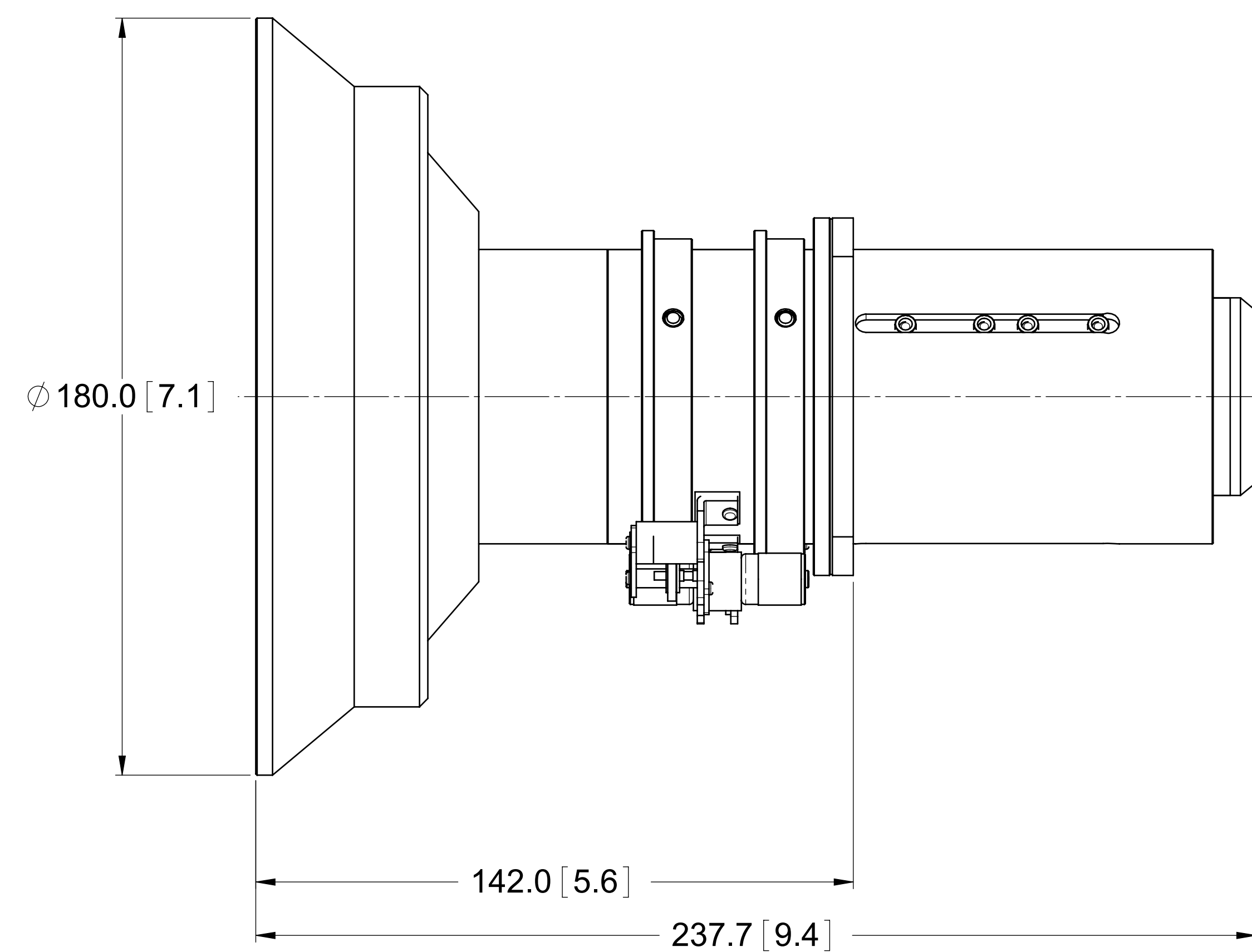

**133-104106-XX**  
4.0-7.0:1 LONG ZOOM

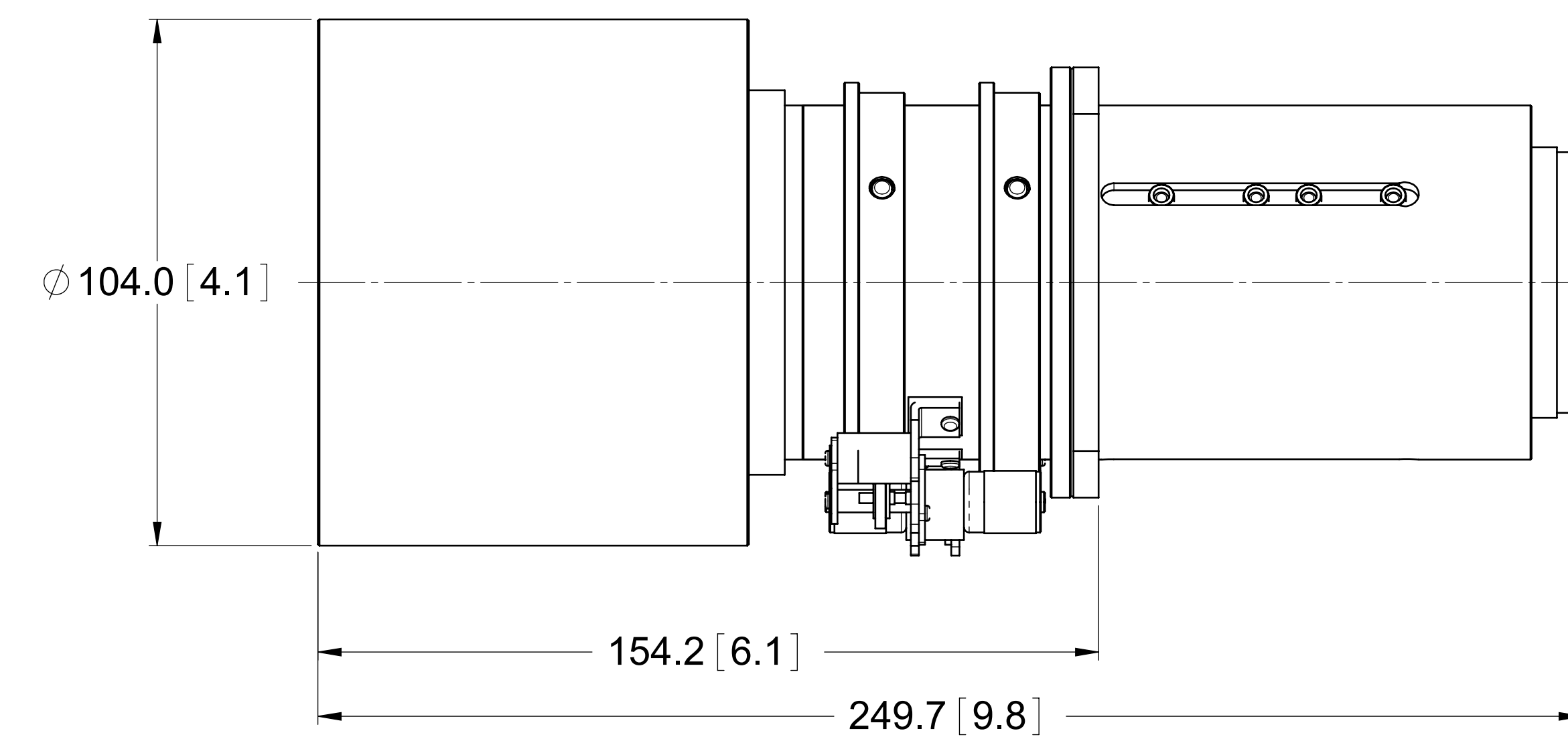

**133-102104-XX**  
1.5-2.0:1 ZOOM

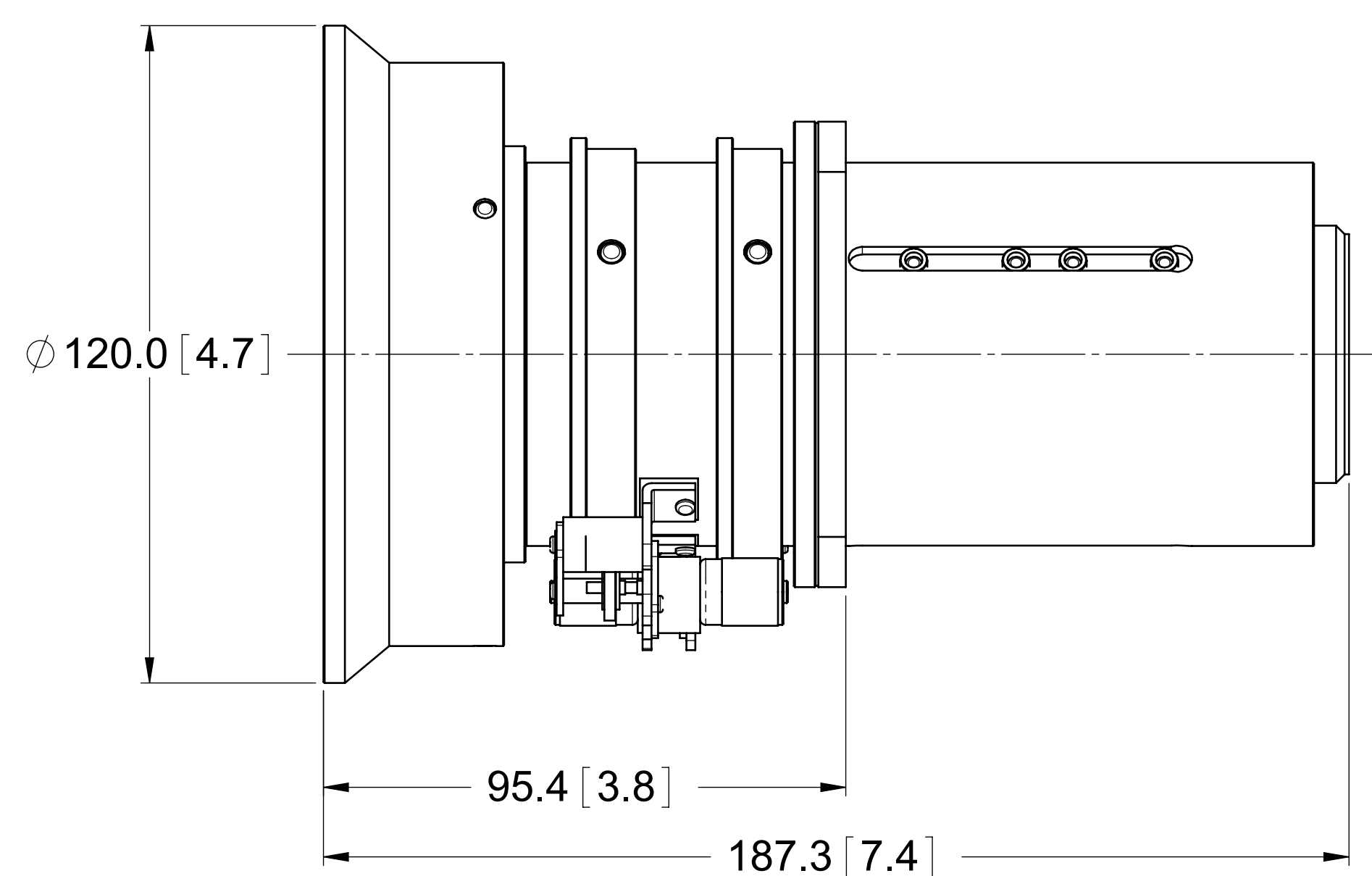

PART NUMBER	DESCRIPTION	SHIPPING WEIGHT	LENS WEIGHT
133-100102-01	0.8 :1 FIXED SHORT	2.6 kg (5.7 lbs)	1.27 kg (2.8 lbs)
133-101103-01	1.2-1.5:1 SHORT ZOOM	3.9 kg (8.6 lbs)	2.46 kg (5.4 lbs)
133-102104-01	1.5-2.0:1 ZOOM	3.1 kg (6.8 lbs)	1.69 kg (3.7 lbs)
133-103105-01	2.0-4.0:1 ZOOM	3.4 kg (7.5 lbs)	2.05 kg (4.5 lbs)
133-104106-01	4.0-7.0:1 LONG ZOOM	3.2 kg (7.1 lbs)	1.85 kg (4.1 lbs)